

Key

A522 Eastbound traffic. ---

A50/A522 Westbound traffic. ---

Extent of third lane deletion (Eastbound and Westbound).

Note:  
 Drawing to be used for assessing extent of third lane deletion travelling eastbound from Stramshall to McDonalds roundabout only; not for construction purposes.  
 Refer to Planning Application ES.18/04 for widening deletion supporting documents and associated drawings.

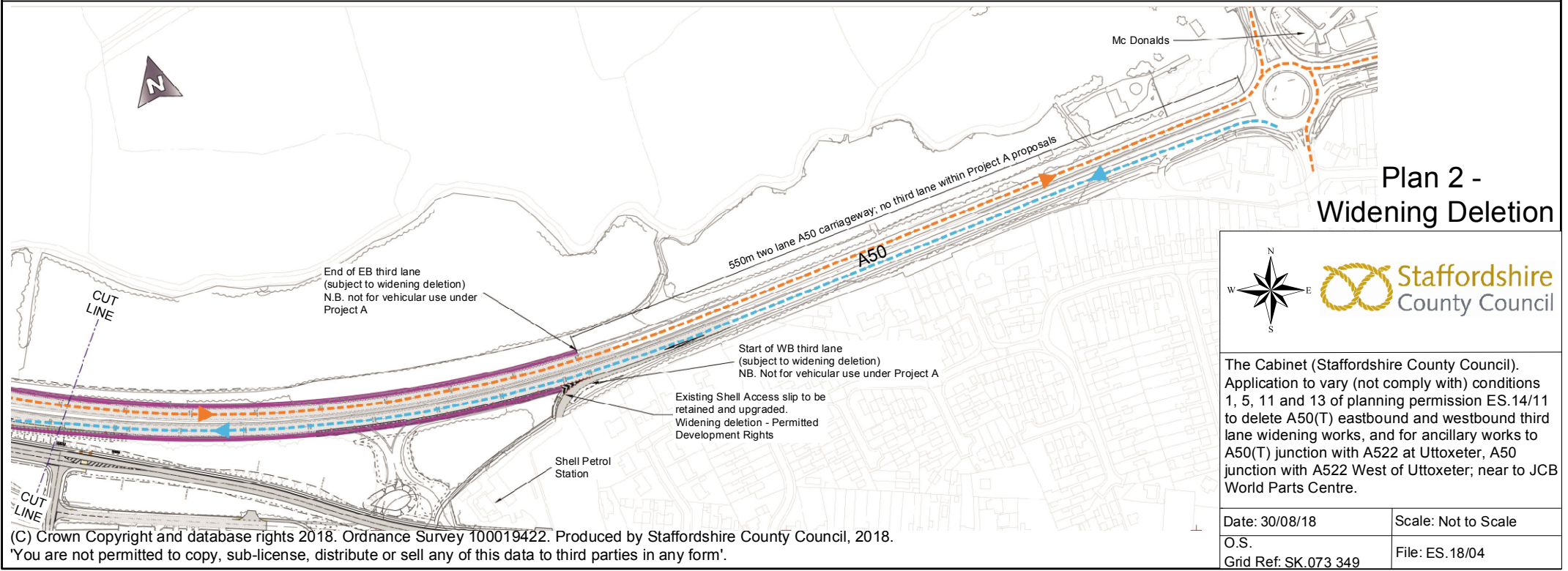

## Plan 2 - Widening Deletion



The Cabinet (Staffordshire County Council). Application to vary (not comply with) conditions 1, 5, 11 and 13 of planning permission ES.14/11 to delete A50(T) eastbound and westbound third lane widening works, and for ancillary works to A50(T) junction with A522 at Uttoxeter, A50 junction with A522 West of Uttoxeter; near to JCB World Parts Centre.

Date: 30/08/18	Scale: Not to Scale
O.S. Grid Ref. SK.073 349	File: ES.18/04

(C) Crown Copyright and database rights 2018. Ordnance Survey 100019422. Produced by Staffordshire County Council, 2018.  
 'You are not permitted to copy, sub-license, distribute or sell any of this data to third parties in any form'.